

TRIBHUVAN UNIVERSITY
INSTITUTE OF ENGINEERING
Examination Control Division
2081 Baishakh

Exam.	Regular(New Course -2080 Batch)		
Level	BE	Full Marks	30
Programme	All(Except BCE, BAR)	Pass Marks	12
Year / Part	I / I	Time	3 hrs.

Subject: - Engineering Drawing (ME 101)

- ✓ Candidates are required to give their answers in their own words as far as practicable.
- ✓ Attempt All questions.
- ✓ The figures in the margin indicate Full Marks.
- ✓ Assume suitable data if necessary.

1. A circle of 50 mm diameter rolls on a horizontal surface. Draw the locus of a fixed point on the circumference of the circle for one complete revolution. Name the curve. [3]
2. Top view of a straight line 50 mm long measures 40 mm. The line is on the VP with its lower end 12 mm above the HP. Draw its projections and determine its inclination with the HP. [3]

OR

Determine the true shape of the triangular plane ABC shown in figure below and its inclination with the HP. [3]

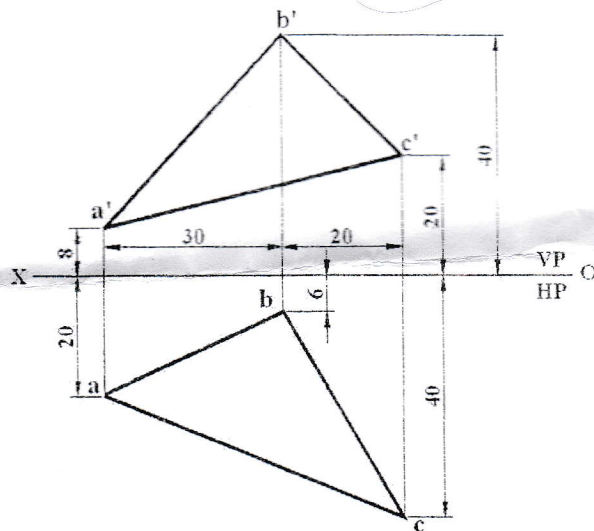

3. Pictorial view of an object is shown in figure below. Draw (with dimension) its (a) sectional front view and (b) top view. [9]

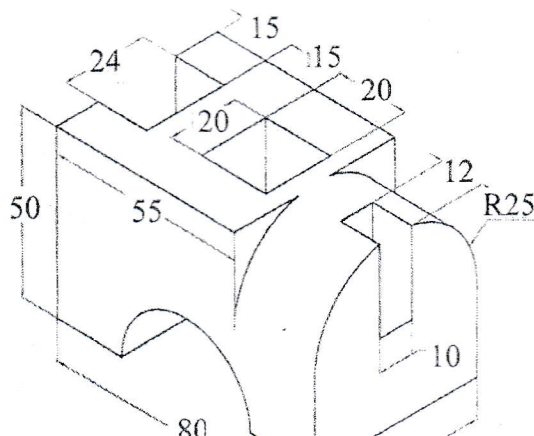

4. Draw front and top views of a right solid cut by a plane as shown in figure below. Find the true shape of the section. Then develop lateral surface of the solid. [8]

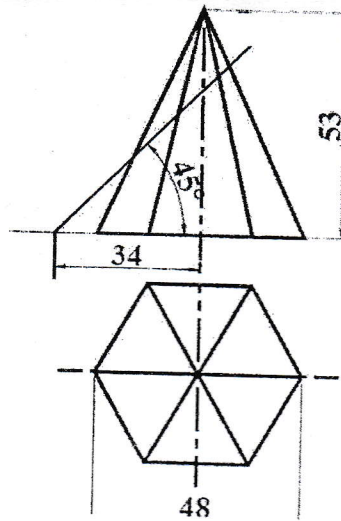

OR

- Draw the lines of intersection of the surfaces of geometrical solids shown in figure below. Also develop the lateral surface of the vertical solid. [8]

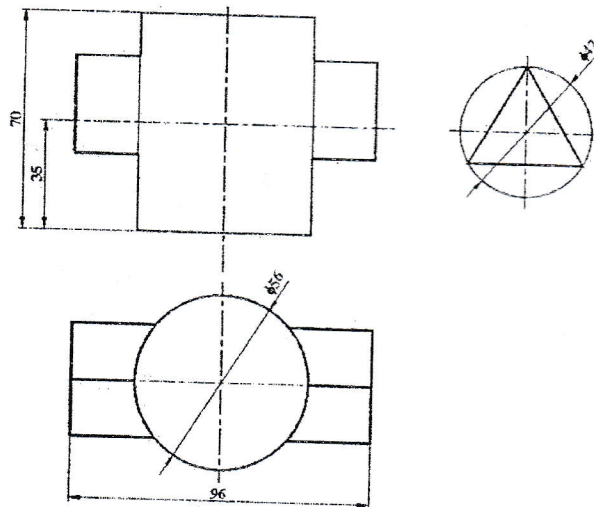

5. Draw isometric drawing from the given orthographic views as shown in figure below. [7]

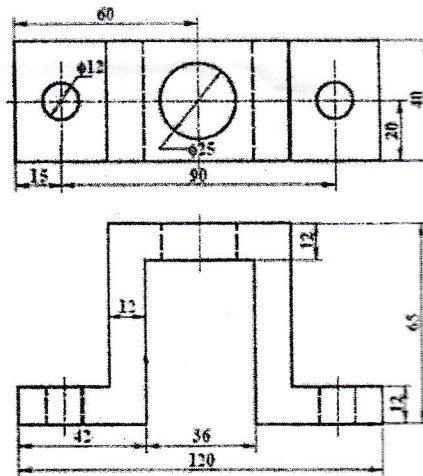

OR

- Draw oblique drawing from the given orthographic views as shown in figure below. [7]

